

# ASAP LOCK

ANSI / ASSE: Z359.15

Patented

Mobile fall arrester for rope  
Antichute mobile sur corde

## WARNING / ATTENTION

Activities involving the use of this equipment are inherently dangerous. You are responsible for your own actions and decisions.

Before using this equipment, you must:

- Read and understand all Instructions for Use.
- Get specific training in its proper use.
- Become acquainted with its capabilities and limitations.
- Understand and accept the risks involved.

**FAILURE TO HEED ANY OF THESE WARNINGS MAY RESULT IN SEVERE INJURY OR DEATH.**

Les activités impliquant l'utilisation de cet équipement sont par nature dangereuses. Vous êtes responsables de vos actes, de vos décisions et de votre sécurité.

Avant d'utiliser cet équipement, vous devez :

- Lire et comprendre toutes les instructions d'utilisation.
- Vous former spécifiquement à l'utilisation de cet équipement.
- Vous familiariser avec votre équipement, apprendre à connaître ses performances et ses limites.
- Comprendre et accepter les risques induits.

**LE NON-RESPECT D'UN SEUL DE CES AVERTISSEMENTS PEUT ÊTRE LA CAUSE DE BLESSURES GRAVES OU MORTELLES.**

PETZL.COM

Latest version  
Dernière version

Other languages  
Autres langues

Technical tips  
Conseils techniques

PPE checking  
Fiche de contrôle EPI

Warning symbols  
Panneaux d'alertes



PETZL  
FR-38920 Croiles  
Cidex 105A  
PETZL.COM  
ISO 9001 © Petzl  
Tel: +33 (0)4 76 92 09 00



Sustaining our Community  
Au service de la Communauté  
FONDATION-PETZL.ORG



Traceability and markings  
Traçabilité et marquage

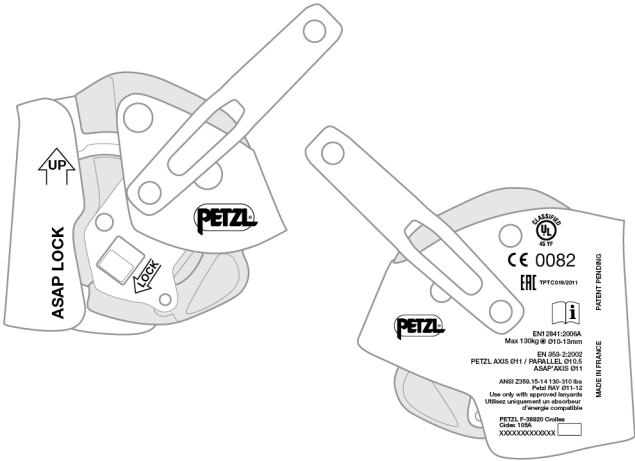
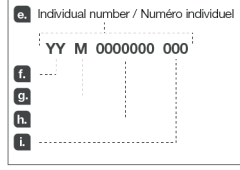
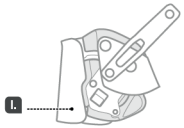

1. Field of application (text part)  
Champ d'application (partie texte)

2. Nomenclature

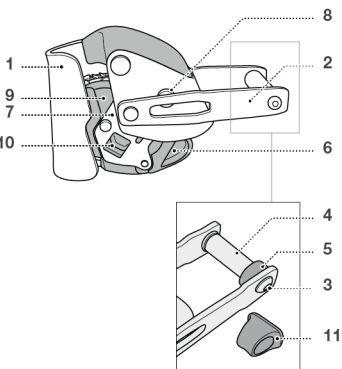

3. Inspection, points to verify  
Contrôle, points à vérifier



PPE checking  
Vérification EPI  
PETZL.COM



ASAP LOCK — B071BA00

FALL ARRESTER  
IN ACCORDANCE WITH  
ANSI/ASSP Z359.15-2014

4. Compatibility  
Compatibilité

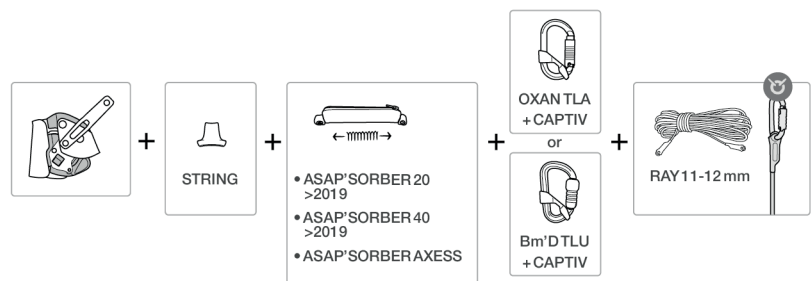
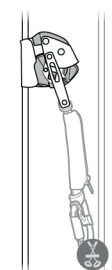

## 5. Working principle Principe fonctionnement

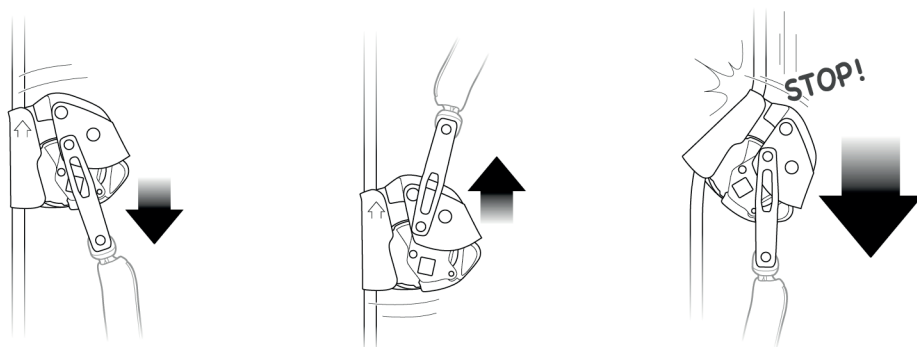

## 6. Installation and function test Mise en place et test de fonctionnement

### Preparation / Préparation

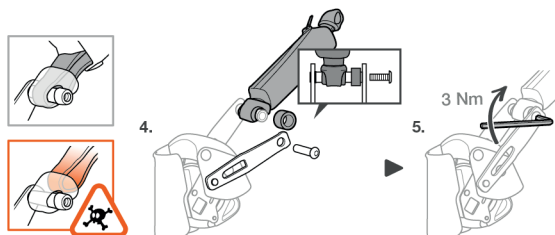
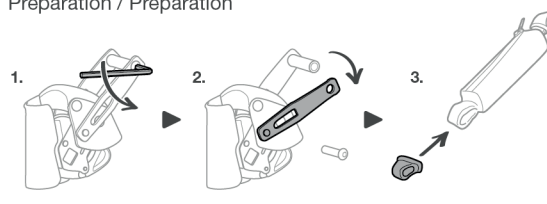

### Attachment to the harness Connexion au harnais



or

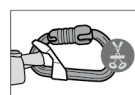

Bm'D TLU  
+ CAPTIV



### Installation Installation

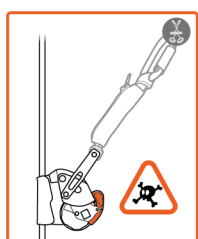
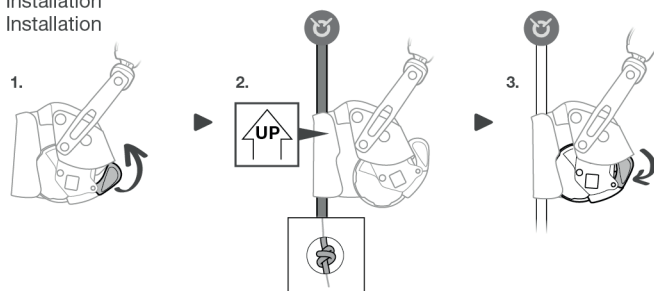

### Test

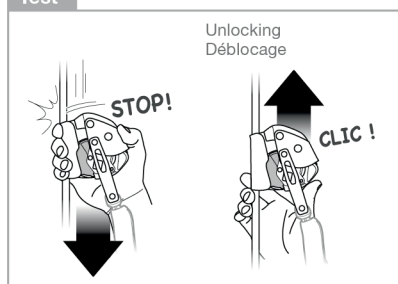

7. Precautions for use  
Précautions d'utilisation

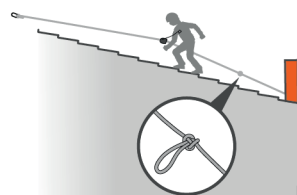
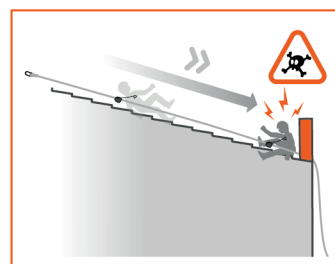
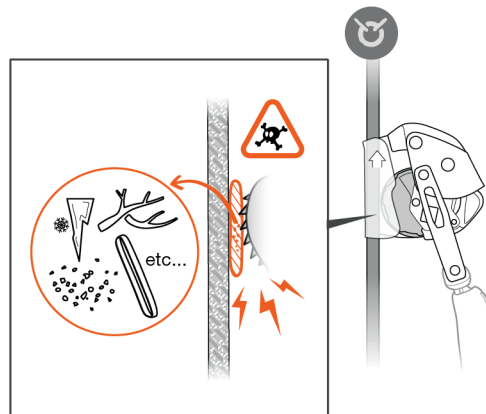
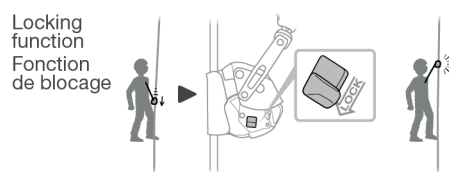
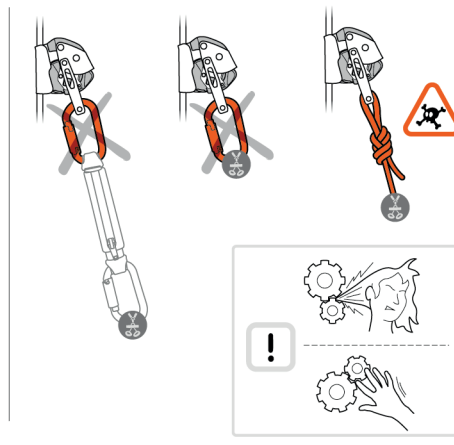
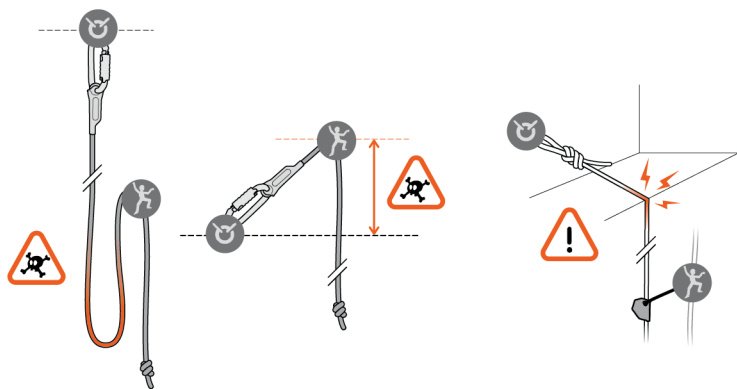

## 8. Clearance Tirant d'air

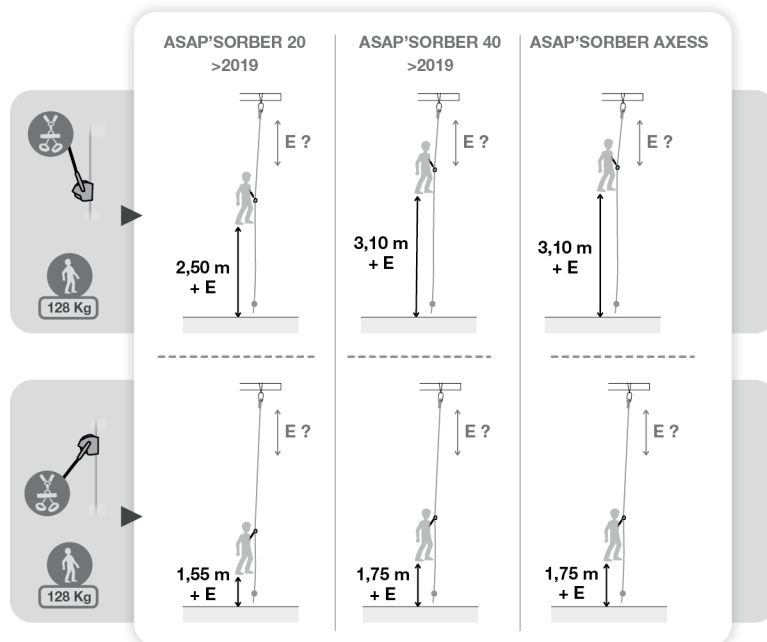

## 9. Cleaning (text part) Nettoyage (partie texte)

### 10. Additional information Informations complémentaires

#### A. Lifetime / Durée de vie

unlimited  
illimitée

#### B. Acceptable T° / T° tolérées

+ 50°C / + 122°F  
- 20°C / - 4°F

#### C. Precautions for use / Précautions d'usage



#### D. Cleaning / Nettoyage



#### E. Drying / Séchage

+ 30°C maxi.  
+ 86°F maxi.

#### F. Storage - Transport / Stockage - transport

+ 30°C / + 86°F  
+ 10°C / + 50°F

#### G. Maintenance Entretien



#### H. Modifications - Repairs Modifications - Réparations



#### I. FAQ - Contact Questions - Contact



# Marlow<sup>®</sup>

## DATASHEET

### STATIC ROPES

Marlow Static LSK is a low stretch kernmantle rope designed for rope access, work positioning, caving and abseiling. Static LSK ropes are manufactured using high quality high tenacity polyamide and significantly out perform the standard CE 1891 test standards with outstanding dynamic properties.

Compatible with all relevant diameter rope management, climbing and descending devices. Static LSK is available in a range of flecked or solid colours and have a visible year of manufacture marker as standard.

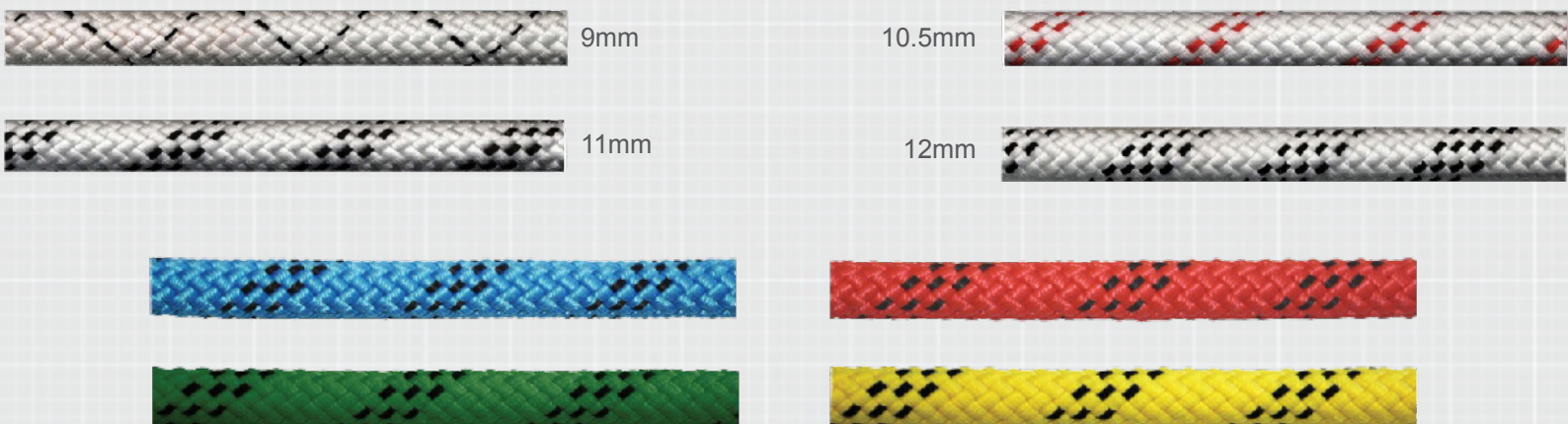

Solid colour options

---

#### MATERIAL (9mm, 10.5mm, 11mm and 12mm Static)

<b>MATERIAL CORE:</b>	High Tenacity Polyamide (Nylon)
<b>MATERIAL COVER:</b>	High Tenacity Polyamide (Nylon)
<b>CORE TYPE:</b>	Multiple twisted cores
<b>COVER TYPE:</b>	16 plait Braided (32 carrier)
<b>CERTIFICATION:</b>	EN 1891 and UKCA

---

#### CONSTRUCTION

##### MANUFACTURED FROM HIGH TENACITY NYLON

Light weight  
High strength  
High energy absorption  
Good resistance to most chemicals and UV  
Improved abrasion resistance  
Aids handling and works well with ascenders and descenders

##### TWISTED FIBRE COVER CONSTRUCTION:

##### SOLID COLOUR OPTIONS (11MM AND 12MM ONLY):

Easily identification of ropes in complex rigging or for different applications

##### SOLID BLACK OPTION:

All ropes are available in black for military and police applications

---



## TERMINATIONS

### TERMINATION OPTIONS:

All Marlow's Static ropes can be terminated with a figure of eight knot. All Static ropes can be terminated with a CE approved sewn eye. This is produced in Marlow's factory using the latest computer controlled sewing machinery. Each eye is individually serial numbered.



## PERFORMANCE

PROPERTY	9mm	10.5mm	11mm	12mm
Rope classification Type (A or B)	B	A	A	A
Diameter (mm)	9.1	10.4	11	12
Sheath Slippage (%)	0	0	0.4	0.2
50-150kg elongation (%)	3.3	2	2.4	1.9
Shrinkage (%)	4.5	5	4	4.3
Mass Core (g/m)	28.5	34.7	40.6	56.8
Mass Cover (g/m)	24.5	32.5	33.1	33.6
Mass Rope (g/m)	53.0	67.2	73.8	90.3
Minimum Static Strength ex. terminations (kN)	18	22	22	22
Average Static Strength ex. terminations (kN)	25.4	33.4	35.3	42.8
Minimum Static Strength with terminations (kN)	12	15	15	15
Average Static Strength with sewn eye (kN)	18.5	25.1	30.9	36.2
Average Static Strength with fig. 8 loop (kN)	13.7	19.5	21.1	24.3
Average Static Strength with spliced eye (kN)	N/A	N/A	N/A	N/A
Fall Factor 1 falls. Fig. 8 loop	6	10+	10+	10+
Fall Factor 1 falls, Spliced eye	N/A	N/A	N/A	N/A
Peak Force (kN). Fig 8 loop	4.6	5.6	5.8	5.5
Peak Force (kN). Spliced eye	N/A	N/A	N/A	N/A

Marlow Ropes Ltd  
Ropemaker Park  
Hailsham  
East Sussex, BN27 3GU  
England

Marlow Ropes, Inc.  
Cordage Business Park  
Plymouth  
MA 02360  
USA

www.marlowropes.com  
UK: +44 (0) 1323 444 444  
sales@marlowropes.com  
US: +1 508 830 444  
salesusa@marlowropes.com

### Disclaimer

Marlow Ropes Ltd endeavours to ensure that all products are manufactured to the highest standard, these guidelines are not intended and do not create any warranties, express or implied. Marlow Ropes Ltd expressly disclaims warranties or representations of any kind, express or implied, including the implied warranties of merchantability and fitness for a particular purpose. Marlow Ropes Ltd shall not be liable for any consequential, incidental or contingent damages whatsoever stemming from the use of these guidelines. Marlow Ropes Ltd has a policy of continual improvement which may result in specification and colour changes without prior notice.

MA-DA-077 | ISSUE NO.2



Certification Number 315  
ISO 9001



# OXAN / VULCAN (international version) (TRIACT-LOCK)

ANSI/ASSP Z359.12  
CSA Z259.12

CE 0082

EN 362

UK  
CA  
0120

EAC

TPTC  
019/2011

NFPA  
ANSI/ASSP:  
Z459.1 [2021]

Steel locking connectors  
Connecteurs acier à verrouillage

## WARNING / ATTENTION

Activities involving the use of this equipment are inherently dangerous. You are responsible for your own actions and decisions.

Before using this equipment, you must:  
- Read and understand all Instructions for Use.  
- Get specific training in its proper use.  
- Become acquainted with its capabilities and limitations.  
- Understand and accept the risks involved.



**FAILURE TO HEED ANY OF THESE WARNINGS MAY RESULT IN SEVERE INJURY OR DEATH.**

Les activités impliquant l'utilisation de cet équipement sont par nature dangereuses. Vous êtes responsable de vos actes, de vos décisions et de votre sécurité.

Avant d'utiliser cet équipement, vous devez :  
- Lire et comprendre toutes les instructions d'utilisation.  
- Vous former spécifiquement à l'utilisation de cet équipement.  
- Vous familiariser avec votre équipement, apprendre à connaître ses performances et ses limites.  
- Comprendre et accepter les risques induits.



**LE NON-RESPECT D'UN SEUL DE CES AVERTISSEMENTS PEUT ÊTRE LA CAUSE DE BLESSURES GRAVES OU MORTELLES.**

Traceability and markings / Traçabilité et marquage

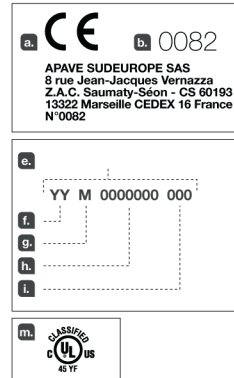
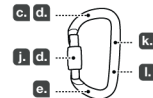
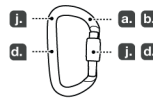

PETZL.COM



Latest version  
Dernière version



Other languages  
Autres langues



Technical tips  
Conseils techniques



PPE checking  
Fiche de contrôle EPI

Warning symbols  
Panneaux d'alertes



PETZL  
FR-38920 Crolles  
Cidex 105A  
PETZL.COM  
ISO 9001 © Petzl



Sustaining our Community  
Au service de la Communauté  
FONDATION-PETZL.ORG

### NFPA CERTIFICATION

MEETS THE CARABINER REQUIREMENTS OF NFPA 1983,  
INCORPORATED IN THE 2022 EDITION OF  
NFPA 2500.

### CERTIFICATION NFPA

CONFORMES AUX EXIGENCES NFPA 1983,  
DE L'ÉDITION 2022 DE LA NFPA 2500 POUR LES CONNECTEURS.



### T (TECHNICAL USE) MEETS NFPA 2500 (1983) - 2022

OXAN M72A TLA - MBS 38 kN  
OXAN M72A TLN - MBS 38 kN

### G (GENERAL USE) MEETS NFPA 2500 (1983) - 2022

VULCAN M073CA00 - MBS 45 kN  
VULCAN M073CA01 - MBS 45 kN

After removing the Instructions for Use from the equipment, make a copy of it and keep the original as part of a permanent record that includes the usage and inspection history for the equipment. Keep the copy of the Instructions for Use with the equipment and refer to it before and after each use. Additional information regarding auxiliary equipment can be found in NFPA 1500 and NFPA 1858 and NFPA 1983, incorporated in the 2022 edition of NFPA 2500.

Après avoir détaché la notice du produit, faites une copie et gardez l'original dans un dossier qui compile l'historique de vie du produit et les vérifications EPI réalisées. Gardez une version de la notice avec le produit et consultez-la avant et après chaque utilisation. Des informations complémentaires sont disponibles dans la NFPA 1500, NFPA 1858 et NFPA 1983, incorporées dans l'édition 2022 de la norme NFPA 2500.



### OXAN

CSA Z259.12-2016  
ANSI Z359.12-2019

### VULCAN

CSA Z259.12-2016  
ANSI Z359.12-2019

### OXAN (international version)

TRIACT-LOCK



38 kN

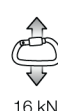

16 kN



15 kN

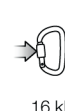

16 kN



16 kN

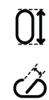

110 mm



19 mm

### VULCAN (international version)

TRIACT-LOCK



45 kN



16 kN



18 kN



16 kN



16 kN



127 mm



26 mm

## 1. Field of application (text part) Champ d'application (partie texte)

## 2. Nomenclature

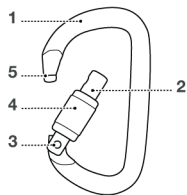

## 3. Inspection, points to verify Contrôle, points à vérifier

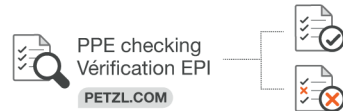

## 4. Compatibility (text part) Compatibilité (partie texte)

## 5. Carabiner positioning Positionnement du connecteur

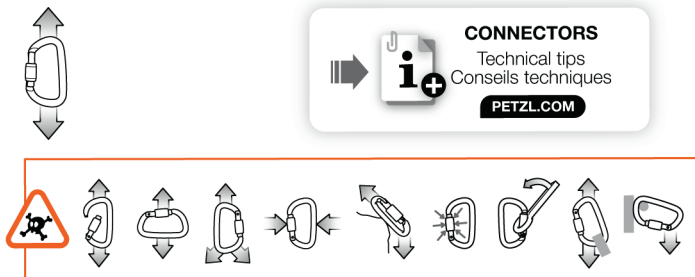

UK  
CA  
0120

This product is compliant with the Regulation 2016/425 on Personal Protective Equipment as brought into UK law and amended. Ce produit est conforme au règlement 2016/425 sur les équipements de protection individuelle tel que transposé en droit britannique et modifié.

Approved Body performing the UKCA type examination:  
Organisme approuvé intervenant pour l'examen UKCA de type :

**SATRA Technology Centre Limited**  
Wyndham Way, Telford Way,  
Kettering, Northamptonshire,  
NN16 8SD, United Kingdom.  
N° 0321

Approved body responsible for the production control of this PPE:  
Organisme approuvé responsable du contrôle de production de cet EPI :

**SGS United Kingdom Ltd**  
Inward Way  
Rossmore Business Park  
Ellesmere Port, Cheshire, CH65 3EN  
United Kingdom  
N° 0120

Authorized Representative in UK : PETZL UK Agency, Unit 3-7, Tebay Business Park, Old Tebay, Penrith, CA10 3SS, United Kingdom

## 6. Opening/closing Ouverture / Fermeture

### TRIACT-LOCK (TL)

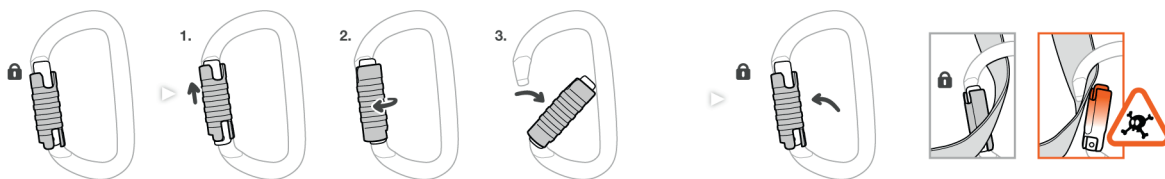

## 7. Additional information Informations complémentaires

### A. Lifetime / Durée de vie



unlimited  
illimitée

### B. Acceptable T° T° tolérées



+ 80°C / + 176°F  
- 40°C / - 40°F

### C. Precautions for use / Précautions d'usage



### D. Cleaning / Nettoyage



### E. Drying / Séchage

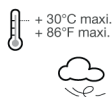

+ 30°C maxi.  
+ 86°F maxi.

### F. Storage - Transport Stockage - transport



### G. Maintenance Entretien



### H. Modifications - Repairs Modifications - Réparations



### I. FAQ - Contact Questions - Contact

