

CONFINED SPACE

Tripod

TRIPOD

The BTS Pro-3 Series 3 stage 3m lightweight aluminium tripod offers workers a practical and user friendly solution for safe means of access & egress including rescue/recovery in vertical confined space applications.



PRODUCT FEATURES

- Individually adjustable telescopic legs with toe spikes, bolt/peg holes and chain holes for added stability.
- BTS-Klick dual action quick release buttons for fast and reliable height adjustment.
- Lightweight aluminium construction.
- Tripod head features integrated pulley wheel allowing for winch wire cable to pass through centre of Tripod.
- Additional rated 3 tie-off points in the Tripod head for attaching additional personal fall protection equipment.
- Powder coated in Hi-Vis Safety Orange for ease of identification in all work areas.
- Compatible for use with other reputable height safety manufacturer's winches.
- Tripod comes complete in canvas storage bag with wheels for ease of storage and transport by one person.
- Minimal set up required - Assembled by one person.
- Use of chain optional.

Weight:	19.8 kg (43.65 lbs)
Maximum Height:	3.02 m (9.90 ft)
Minimum Height:	1.55 m (5.08 ft)
Capacity:	Max. 2 users, 1 person no more than 140kg (310 lbs) per anchor point
Rated:	12kN (2,700 lbs) per anchor point

TRIPOD				
Model Description	Maximum Height m (ft)	Collapsed Height m (ft)	Weight kg (lbs)	Code
PRO-3, 3m 3 stage	3.02 (9.90)	1.55 (5.08)	19.8 (43.65)	40014

PRO-SERIES TRIPOD ACCESSORIES	
Model Description	Code
Tripod Storage bag c/w wheels	30014SCB
Quick Release Double Sided Universal Male Interface Bracket.	60202UAT
Female Single Pro-Series Universal Interface Davit Winch Bracket.	60202UF
Tripod Top Pulley Assembly.	30173
IKAR PRO-Series Davit Bracket c/w Female Single Interface Brackets.	60202UIM
Quick Release Male Tripod Bracket (Tool-less).	30014SB
BTECH Man / Materials Rated Winch with 18, 30, 45, 60, 76 & 90m (59, 98, 147, 196, 249 & 295 ft) wire rope.	See page 42-43
S/S Material Winch c/w Female Interface Bracket with 18m x 6mm (59' x 1/4") HDG W/R with G80 Swivel S/L Hook.	SSJC-C820
S/S Material Winch c/w Female Interface Bracket with 18m x 6mm (59' x 1/4") S/S W/R with G100 Swivel S/L Hook	SSJC-C820S
IKAR Recovery Winch 12, 18 or 24 m (39, 59 or 78 ft).	HRA-12TA, HRA-18TA HRA-24TA
Diversion Sheave Block with S/S Karabiner .	41-Z20
Spreader Bar.	BRO5110



MAN RATED WINCHES

Man Rated Winches & Accessories

STAINLESS STEEL HAND BRAKE WINCH

Designed for use with BTS PRO Series davits & tripods.

PRODUCT FEATURES

- Compact design.
- Rated Capacity: 140Kg (310 lbs) (Lifting) in line with Man Rated PRO-Series davits & tripods.
- 5:1 gear ratio.
- Very low operator effort required for easy operation.
- Double pawl safety feature.
- Stainless steel construction Grade 304.
- Automatic weather proof Weston brake.
- Automatic load actuated breaking system, no free wheeling under load.
- Winch bearings made from bronze for additional corrosion resistance.
- Ergonomic rubber handle.
- Enclosed gear train.
- Minimum handle effort to lift or pull.
- C/w 18m x 6mm (59' x 1/4") 7x19 H.D.G Grade G1970 Wire rope.
- C/w Double Action Swivel Safety Hook with fall arrest indicator.
- Quick Release female Single Universal Interface Bracket c/w locking toggle pin & jack chain lanyard designed specifically to match BTS Universal quick release interface tripod bracket (30014SB) or BTS Quick Release Double Sided Universal Male Interface Bracket (60202UA).

18m x 6mm (59' x 1/4") 7x19
H.D.G Grade G1970 Wire rope

*Note: Stainless Steel wire rope
can be supplied as an option*

STAINLESS STEEL HAND BRAKE WINCH	
Code	Description
SSJC-C820M	Stainless Steel Hand Brake Winches c/w 18m x 6mm (59' x 1/4") 7x19 H.D.G Grade G1970 Wire rope, Double Action Swivel Safety Hook with fall arrest indicator & Quick Release Single Universal Interface Bracket.
SSJC-C820MS	Same as above, but with 6mm 7 X 19 Grade 316 Stainless Steel wire rope.
6028TPS	Replacement toggle pin & jack chain for 60202UF.

Note:

When using these winches for passenger elevation (Man Riding) the person being elevated MUST also be attached to a secondary SRL device. When a person is attached to this winch at NO time shall the person be exposed to a potential fall that could result in an impact greater than 6kN.

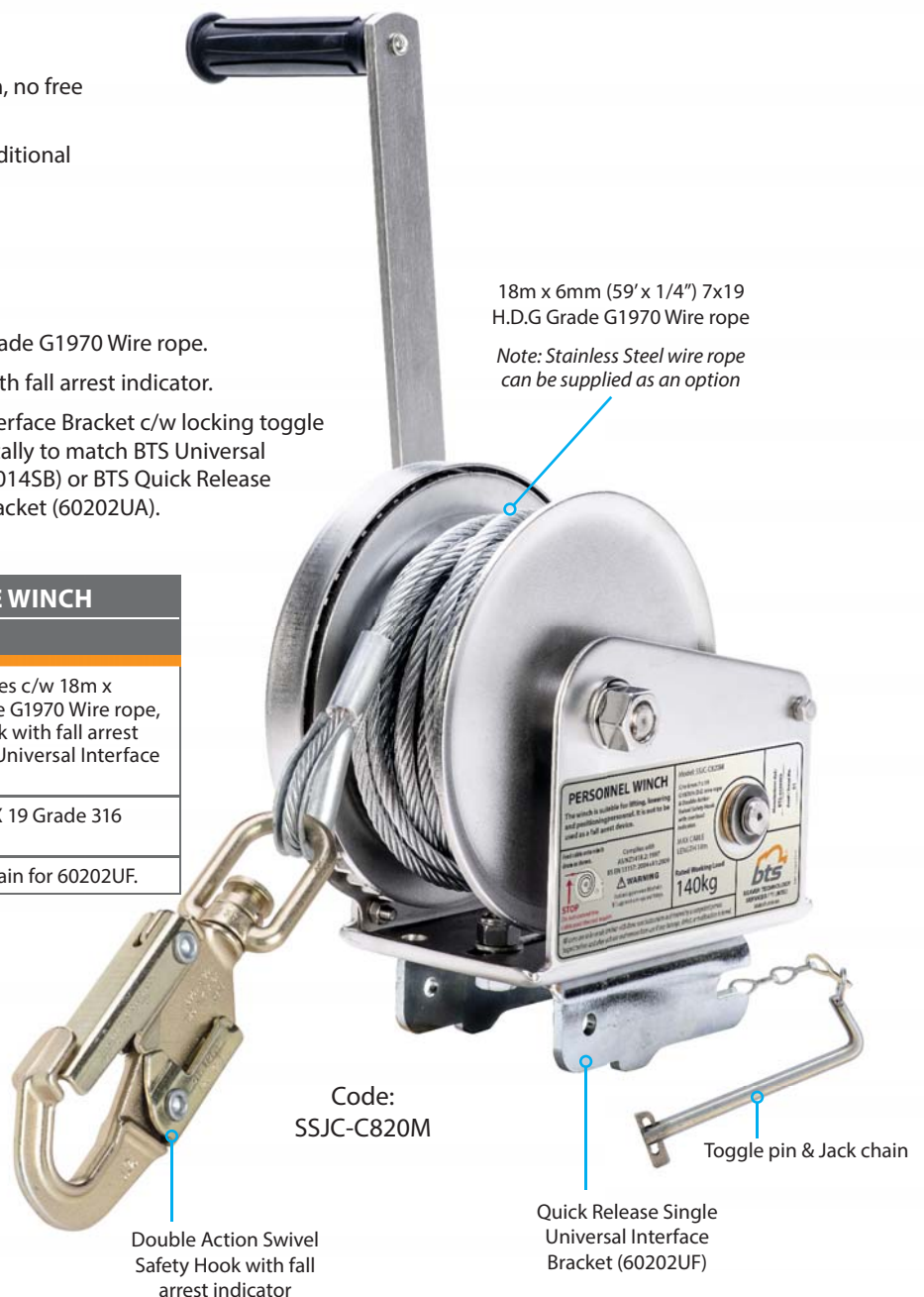



CONFINED SPACE

Tripod Accessories

TRIPOD ACCESSORIES

BTECH® DIVERSION SHEAVE BLOCK

BTECH® anchor point Diversion Sheave Block and Karabiner for attaching a HRA lifeline when a HRA Device is mounted onto an aluminium rescue tripod, or other BTS equipment such as; Davits or AirHooks.

The Diversion Sheave Block is clipped onto the eye at the top of the anchor point with the HRA lifeline passing through it. The pulley is corrosion-resistant stainless steel and comes complete with screw-gate karabiner.

Specifications

Pulley Type:	Single
Pulley Size:	Suits 6-8mm (1/4 - 5/16 in) wire rope.
Weight:	1.1Kg (2.42 lbs)
Rated Capacity:	1 person 140kg (310 lbs) including operator and any equipment.

BTECH® DIVERSION SHEAVE BLOCK	
Code	Description
41-Z20	Diversion Sheave Block with S/S Karabiner.



QUICK RELEASE TRIPOD BRACKET

The Universal quick release interface tripod bracket offers a tool free assembly and remove option on tripods when used in conjunction with a female universal interface bracket (60202UF).



QUICK RELEASE TRIPOD BRACKET	
Code	Description
30014SB	Quick Release Tripod Interface Bracket .

