

1. Field of application (text part)
Champ d'application (partie texte)

5. Strength
Résistance

MOBILE

PARTNER

CE 0082
EN 12278: 2007

UK
CA
0120

UIAA individually tested



Pulley
Poulie

3 year guarantee

MOBILE

PARTNER



$7 < \varnothing < 13 \text{ mm}$

$7 < \varnothing < 11 \text{ mm}$

UIAA

2. Nomenclature
Nomenclature

MOBILE

PARTNER

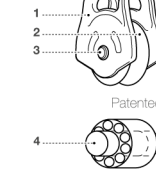
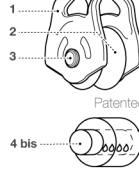

3. Inspection, points to verify
Contrôle, points à vérifier

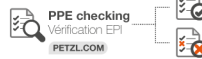

4. Compatibility (text part)
Compatibilité (partie texte)

5A. Working load limit /
Valeur d'utilisation maxi

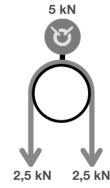

5B. Breaking load /
Charge de rupture

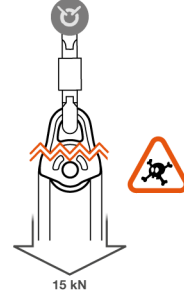

6. Efficiency
Rendement

6A. Simple pulley system

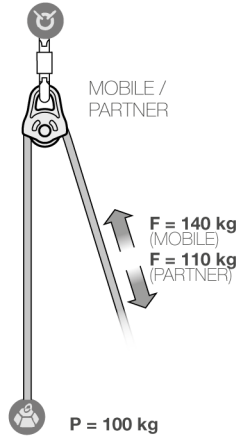

with progress capture

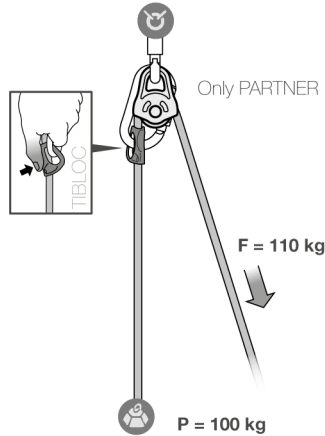

6B. 2:1 hauling system

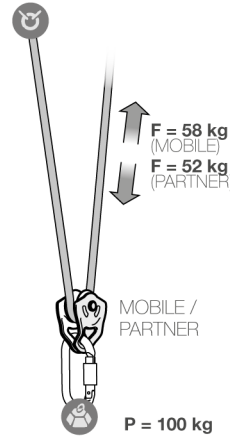

6C. 3:1 hauling system with progress capture

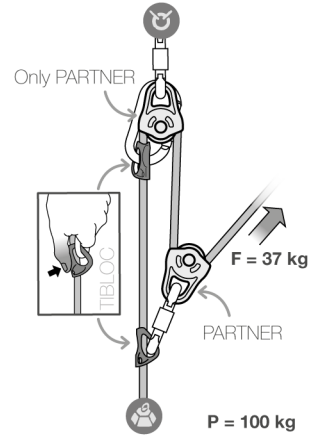

Theoretical force

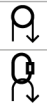

	MOBILE	PARTNER		MOBILE	PARTNER		MOBILE	PARTNER
	$F = P$	$F = P$		$F = 0,5 P$	$F = 0,5 P$		$F = 0,33 P$	
	$F = 1,4 P$	$F = 1,1 P$		$F = 0,58 P$	$F = 0,52 P$		$F = 0,37 P$	
	$F = 2 P$	$F = 2 P$		$F = 0,66 P$	$F = 0,66 P$		$F = 0,57 P$	

7. Progress capture systems
Systèmes anti-retour

TIBLOC + PARTNER
Occasional use
Utilisation occasionnelle

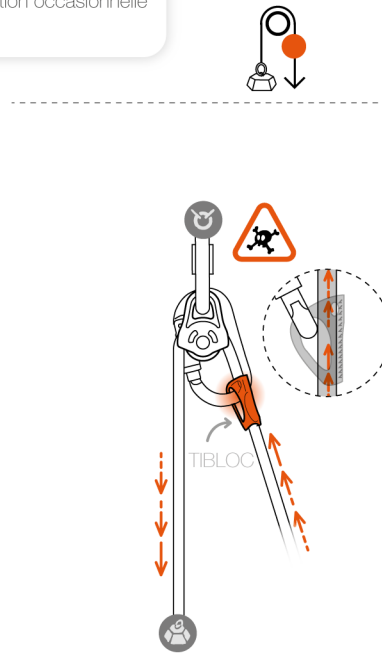
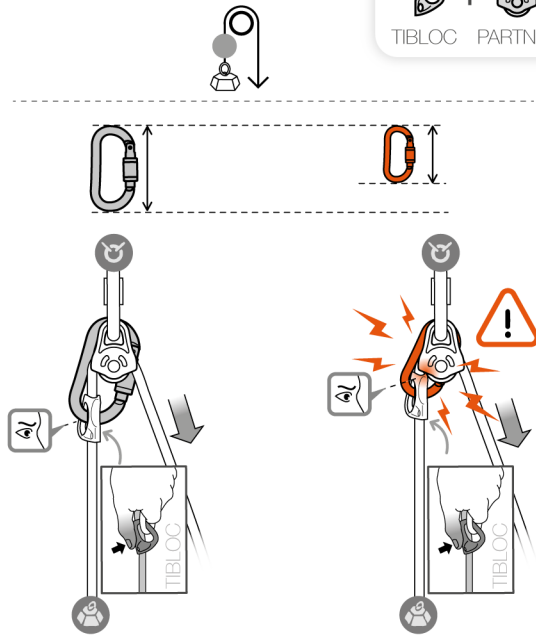

8. Positioning and redirection
Positionnement et renvoi

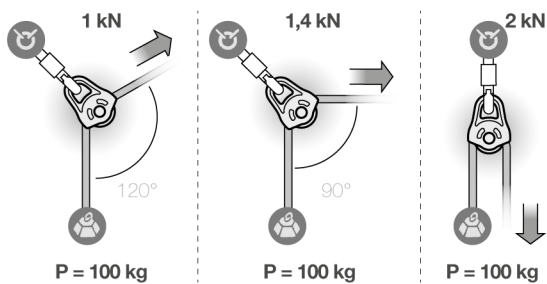
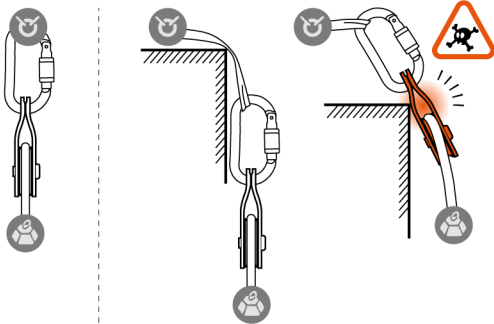

Traceability and markings
Traçabilité et marquage

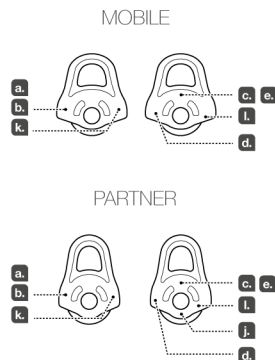

CE b. 0082
Apave Exploitation France SAS
6 Rue du Général Audran
92412 Courbevoie cedex
France
N°0082

c. Traceability: **datamatrix**

d. Diameter

e. Individual number
YY M 0000000 000
f. Year of manufacture
g. Month of manufacture
h. Batch number
i. Individual identifier

j. Standards

k. Carefully read the instructions for use

l. Manufacturer address

UKCA
0120

This product is compliant with the Regulation 2016/425 on Personal Protective Equipment as brought into UK law and amended.
Ce produit est conforme au règlement 2016/425 sur les équipements de protection individuelle tel que transposé en droit britannique et modifié.

Approved Body performing the UKCA type examination:
Organisme approuvé intervenant pour l'examen UKCA de type :

SATRA Technology Centre Limited
Wyndham Way, Telford Way,
Kettering, Northamptonshire,
NN16 8SD, United Kingdom.
N° 0321

Approved body responsible for the production control of this PPE:
Organisme approuvé responsable du contrôle de production de cet EPI :

SGS United Kingdom Ltd
Inward Way
Rossmore Business Park
Ellesmere Port, Cheshire, CH65 3EN
United Kingdom
N° 0120

Authorized Representative in UK: PETZL UK Agency, Unit 3-7, Tabay Business Park, Old Tabay, Penrith, CA10 3SS, United Kingdom